

— Route Alignment
 — Existing A66
 — Order Limits
 — Study Area 100m
 — Study Area 250m
 ■ Camera Trap
 — Watercourses
 — Mammal Riparian Walking Transect Routes
 RCT: Riparian Camera Trap
 CT: Camera Trap

Camera Trap Sightings
 ● Otter
 ● Otter Cubs
 ● Otter Holt
Incidental Records
 ● Water Vole
 ● Otter
Water Vole Field Signs
 ● Feeding Stations/Signs
 ● Other

Otter Field Signs
 ● Feeding Signs
 ● Footprints
 ● Unconfirmed Holt/Resting Place
 ● Other
 ● Paths
 ● Sightings
 ● Slides
 ● Spraint

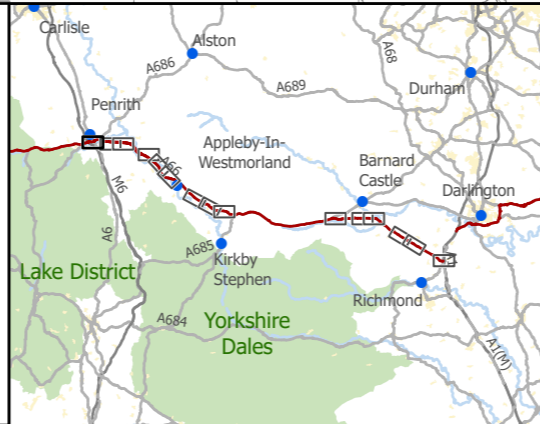

national highways
 3 Piccadilly Place
 Manchester
 M1 3BN

P02	First Issue				
	EREI	CESL	HWHI	AMIT	KWHA
	23/03/22	17/04/22	22/04/22	22/04/22	22/04/22
Revision	Created	Checked	Reviewed	Approved	Authorised

Scale @ A3: 1:10,000 | Project Ref No HE565627 | Stage: Stage 3
 © Crown copyright and database rights (2022). All rights reserved. OS 100030649.
 Contains public sector information licensed under the Open Government Licence v3.0.

Project Name
 A66 Northern Trans-Pennine Project

Map Title
 Figure 6.16
 Otter and Water Vole Survey
 Scheme: 0102, M6 Junction 40 to Kemplay Bank
 Sheet 1 of 15

Map Number	Project	Originator	Volume
HE565627	-	AMY	- EBD
S00	-	MP	- LB - 003165
Location	Type	Role	Number
S4	FIT FOR STAGE APPROVAL		P02

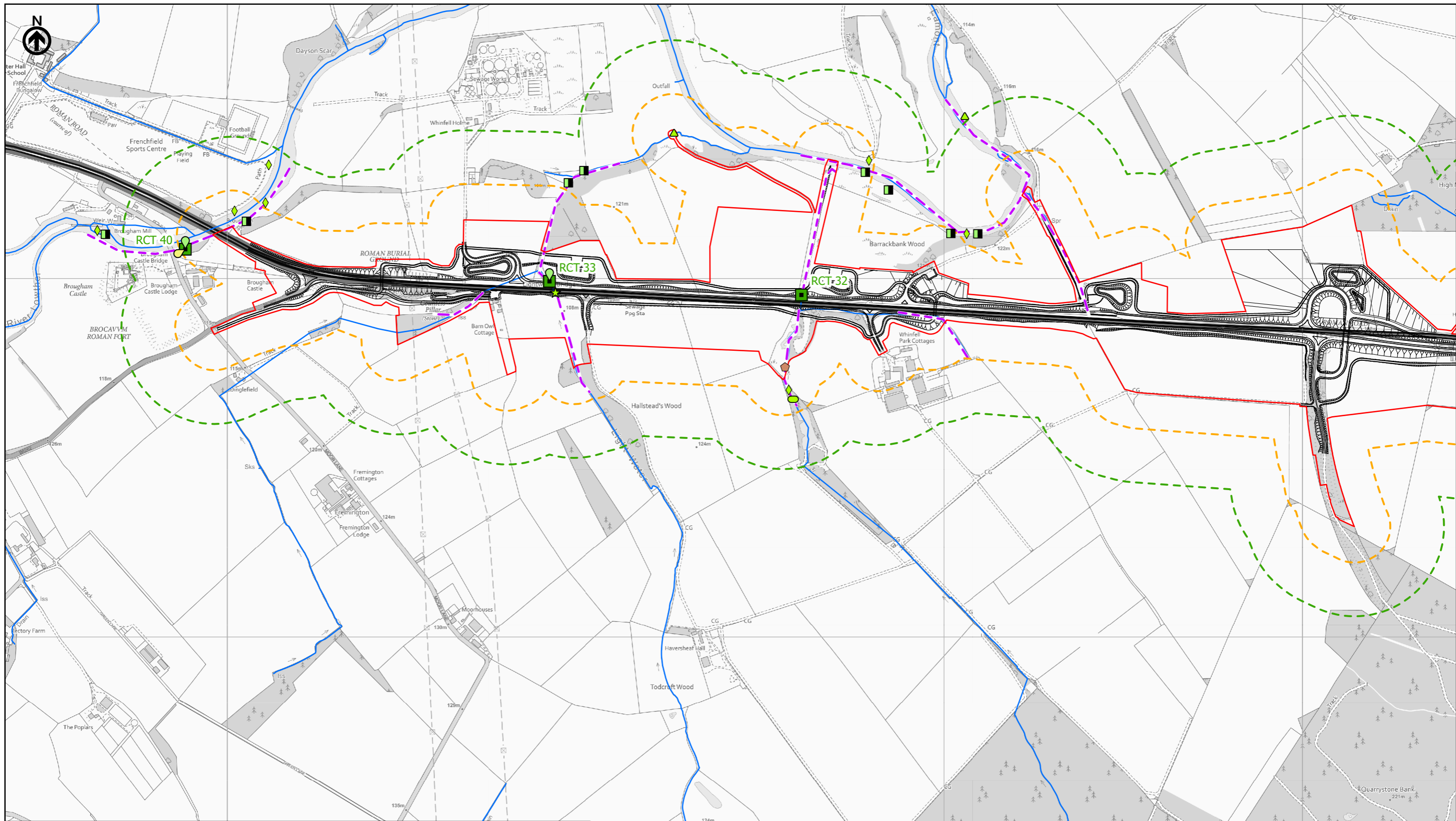

<ul style="list-style-type: none"> — Route Alignment — Existing A66 — Order Limits — Study Area 100m — Study Area 250m ■ Camera Trap — Watercourses — Mammal Riparian Walking Transect Routes 	<p>Camera Trap Sightings</p> <ul style="list-style-type: none"> ● Otter ● Otter Cubs ● Otter Holt <p>Incidental Records</p> <ul style="list-style-type: none"> ● Water Vole ● Otter <p>Water Vole Field Signs</p> <ul style="list-style-type: none"> ● Feeding Stations/Signs ● Other 	<p>Otter Field Signs</p> <ul style="list-style-type: none"> ● Feeding Signs ● Footprints ● Unconfirmed Holt/Resting Place ● Other ● Paths ● Sightings ● Slides ● Spraint
---	---	---

RCT: Riparian Camera Trap
CT: Camera Trap

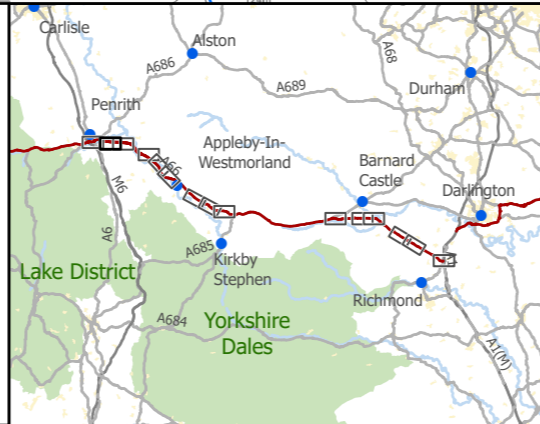

national highways

3 Piccadilly Place
Manchester
M1 3BN

P02	First Issue				
	EREI	CESL	HWHI	AMIT	KWHA
	23/03/22	17/04/22	22/04/22	22/04/22	22/04/22
Revision	Created	Checked	Reviewed	Approved	Authorised

Kilometres
0 0.25 0.5

Scale @ A3: 1:10,000 | Project Ref No HE565627 | Stage: Stage 3
© Crown copyright and database rights (2022). All rights reserved. OS 100030649.
Contains public sector information licensed under the Open Government Licence v3.0.

Project Name A66 Northern Trans-Pennine Project			
Map Title Figure 6.16			
Scheme: 03, Penrith to Temple Sowerby			
Sheet 2 of 15			
Map Number Project	Originator	Volume	
HE565627	AMY	EBD	
S00	-	MP	LB - 003167
Location	Type	Role	Number
S4	FIT FOR STAGE APPROVAL		P02

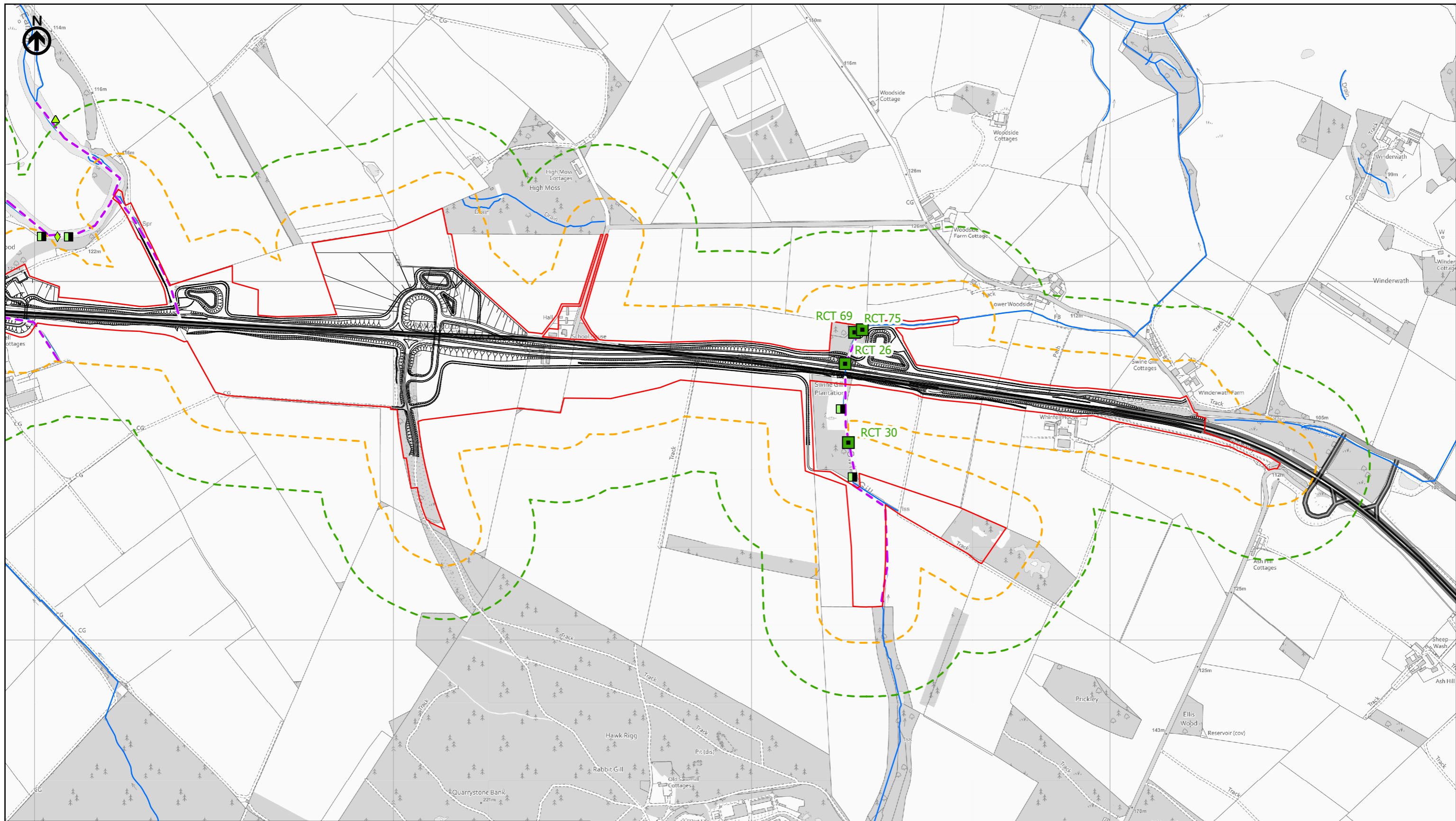

<ul style="list-style-type: none"> — Route Alignment — Existing A66 — Order Limits — Study Area 100m — Study Area 250m ■ Camera Trap — Watercourses — Mammal Riparian Walking Transect Routes 	<p>Camera Trap Sightings</p> <ul style="list-style-type: none"> ● Otter ● Otter Cubs ● Otter Holt <p>Incidental Records</p> <ul style="list-style-type: none"> ● Water Vole ● Otter <p>Water Vole Field Signs</p> <ul style="list-style-type: none"> ● Feeding Stations/Signs ● Other 	<p>Otter Field Signs</p> <ul style="list-style-type: none"> ● Feeding Signs ● Footprints ● Unconfirmed Holt/Resting Place ● Other ● Paths ● Sightings ● Slides ● Spraint
---	---	---

RCT: Riparian Camera Trap
CT: Camera Trap

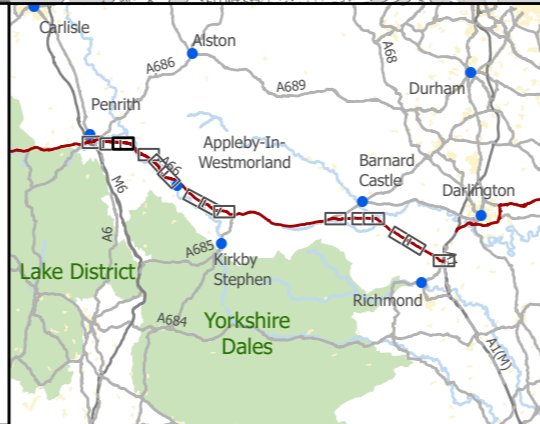

national highways

3 Piccadilly Place
Manchester
M1 3BN

P02	First Issue				
	EREI	CESL	HWHI	AMIT	KWHA
	23/03/22	17/04/22	22/04/22	22/04/22	22/04/22
Revision	Created	Checked	Reviewed	Approved	Authorised

Kilometres
0 0.25 0.5

Scale @ A3: 1:10,000 | Project Ref No HE565627 | Stage: Stage 3
© Crown copyright and database rights (2022). All rights reserved. OS 100030649.
Contains public sector information licensed under the Open Government Licence v3.0.

Project Name A66 Northern Trans-Pennine Project			
Map Title Figure 6.16			
Scheme: 03, Penrith to Temple Sowerby			
Sheet 3 of 15			
Map Number Project	Originator	Volume	
HE565627	AMY	EBD	
S00	MP	LB	003168
Location	Type	Role	Number
S4	FIT FOR STAGE APPROVAL		P02

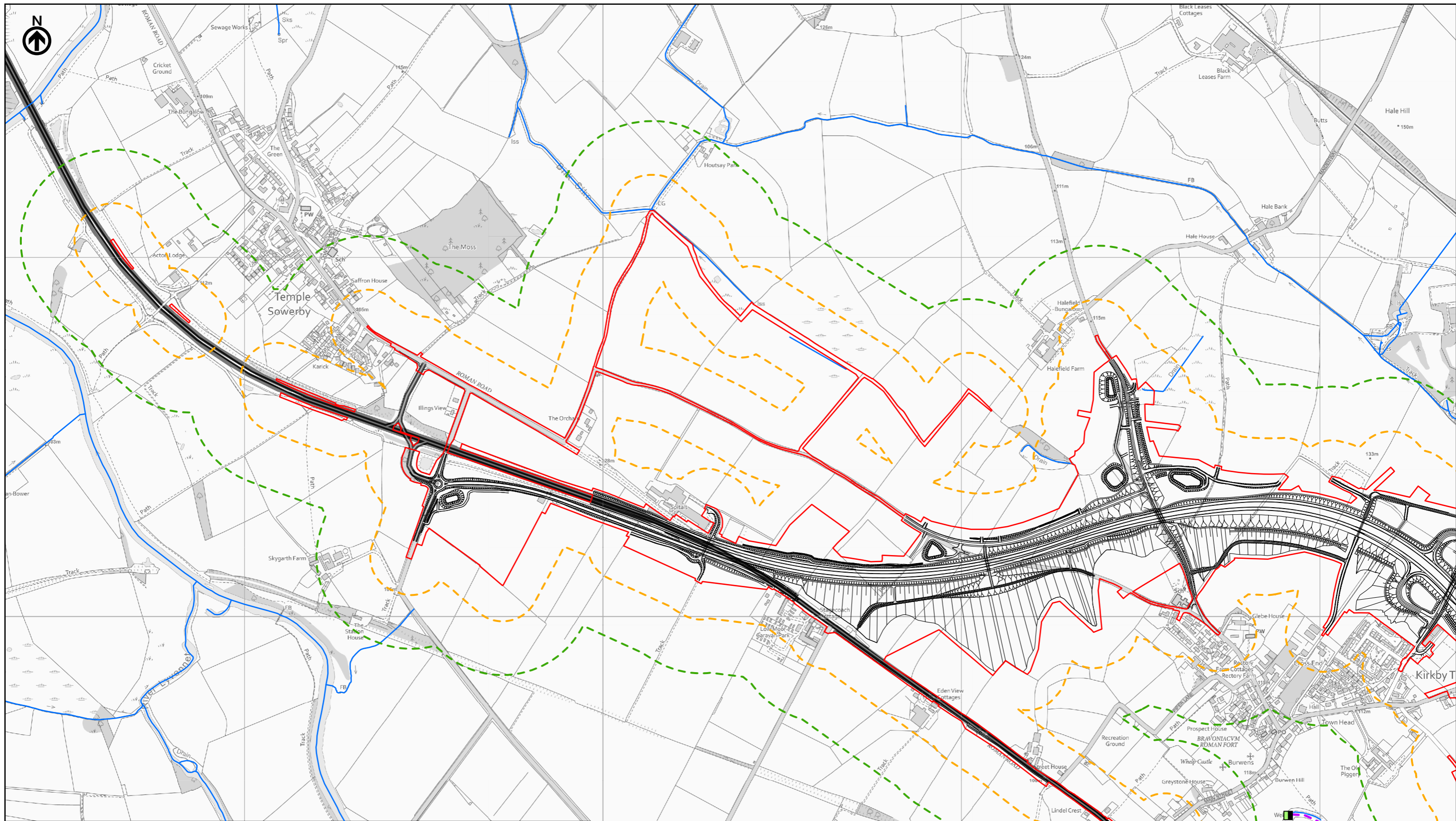

<ul style="list-style-type: none"> — Route Alignment — Existing A66 — Order Limits - - - Study Area 100m - - - Study Area 250m ■ Camera Trap — Watercourses — Mammal Riparian Walking Transect Routes 	<p>Camera Trap Sightings</p> <ul style="list-style-type: none"> ● Otter ● Otter Cubs ● Otter Holt <p>Incidental Records</p> <ul style="list-style-type: none"> ▲ Water Vole ▲ Otter <p>Water Vole Field Signs</p> <ul style="list-style-type: none"> ● Feeding Stations/Signs ● Other 	<p>Otter Field Signs</p> <ul style="list-style-type: none"> ● Feeding Signs ★ Footprints ◆ Unconfirmed Holt/Resting Place ● Other ■ Paths ⊕ Sightings ● Slides ■ Spraint
---	---	---

RCT: Riparian Camera Trap
CT: Camera Trap

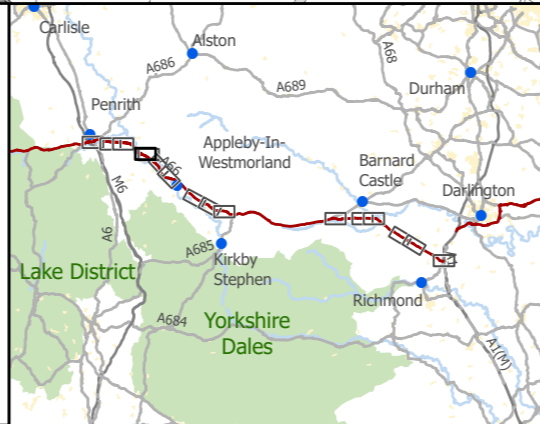

national highways 3 Piccadilly Place Manchester M1 3BN

P02	First Issue				
	EREI	CESL	HWHI	AMIT	KWHA
	23/03/22	17/04/22	22/04/22	22/04/22	22/04/22
Revision	Created	Checked	Reviewed	Approved	Authorised

Kilometres
0 0.25 0.5

Scale @ A3: 1:10,000 | Project Ref No HE565627 | Stage: Stage 3
© Crown copyright and database rights (2022). All rights reserved. OS 100030649.
Contains public sector information licensed under the Open Government Licence v3.0.

Project Name
A66 Northern Trans-Pennine Project

Map Title
Figure 6.16
Otter and Water Vole Survey
Scheme: 0405, Temple Sowerby to Appleby
Sheet 4 of 15

Map Number	Project	Originator	Volume
HE565627	S00	AMY	EBD
Location	Type	Role	Number
S4	FIT FOR STAGE APPROVAL	MP - LB	003169

Suitability	Suitability Description	Revision
S4	FIT FOR STAGE APPROVAL	P02

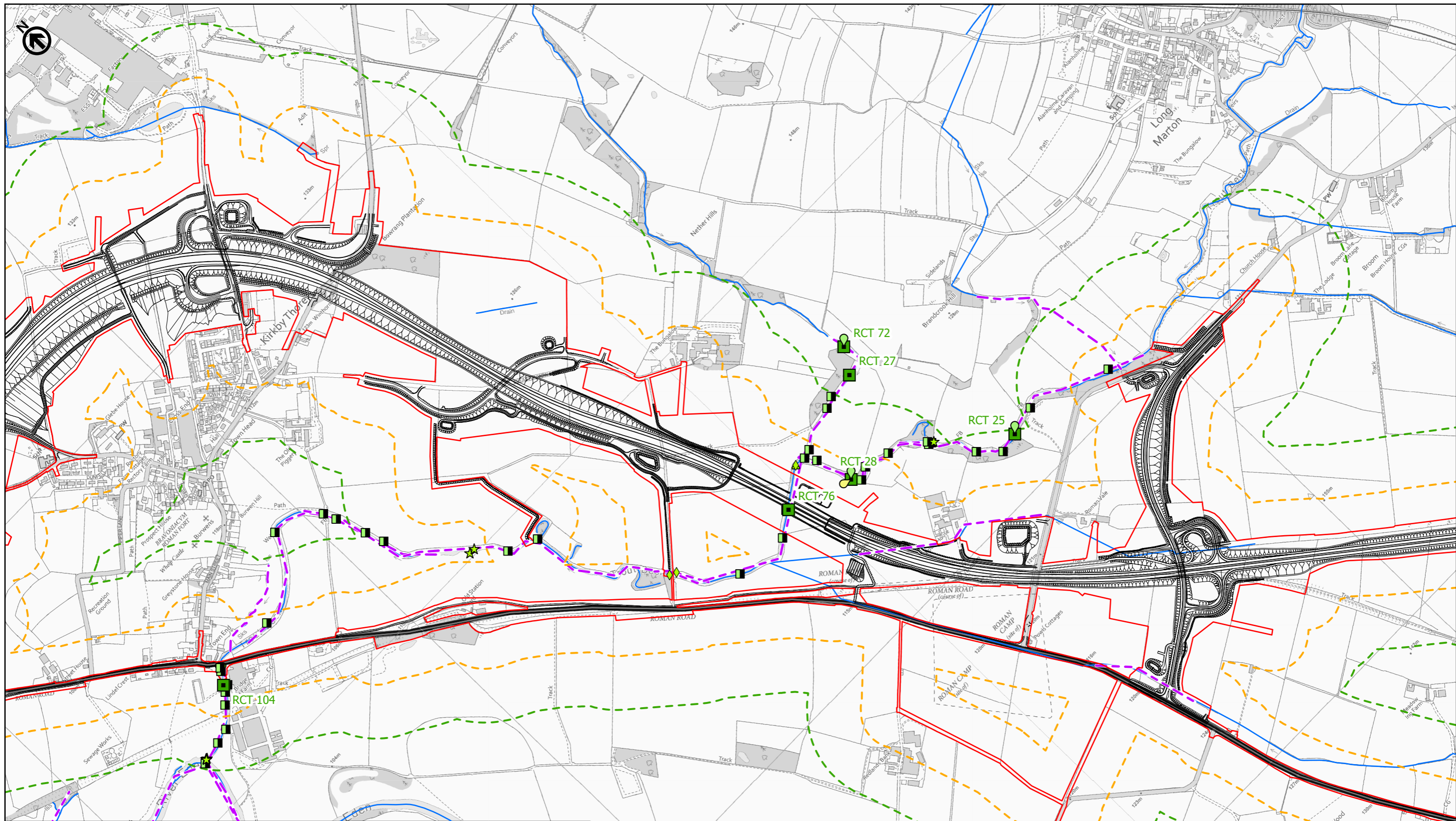

<ul style="list-style-type: none"> — Route Alignment — Existing A66 — Order Limits - - - Study Area 100m - - - Study Area 250m ■ Camera Trap — Watercourses - - - Mammal Riparian Walking Transect Routes 	<p>Camera Trap Sightings</p> <ul style="list-style-type: none"> ● Otter ● Otter Cubs ● Otter Holt <p>Incidental Records</p> <ul style="list-style-type: none"> ▲ Water Vole ▲ Otter <p>Water Vole Field Signs</p> <ul style="list-style-type: none"> ▲ Feeding Stations/Signs ● Other 	<p>Otter Field Signs</p> <ul style="list-style-type: none"> ■ Feeding Signs ★ Footprints ◆ Unconfirmed Holt/Resting Place ● Other ■ Paths + ● Sightings ● Slides ■ Spraint
---	---	--

RCT: Riparian Camera Trap
CT: Camera Trap

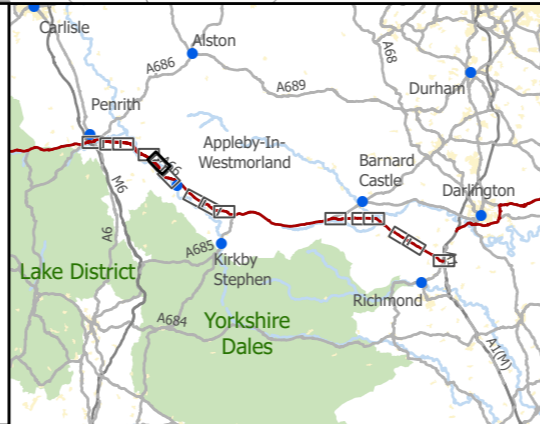

national highways

3 Piccadilly Place
Manchester
M1 3BN

P02	First Issue				
	EREI	CESL	HWHI	AMIT	KWHA
	23/03/22	17/04/22	22/04/22	22/04/22	22/04/22
Revision	Created	Checked	Reviewed	Approved	Authorised

Kilometres

0 0.25 0.5

Scale @ A3: 1:10,000 | Project Ref No HE565627 | Stage: Stage 3
© Crown copyright and database rights (2022). All rights reserved. OS 100030649.
Contains public sector information licensed under the Open Government Licence v3.0.

Project Name
A66 Northern Trans-Pennine Project

Map Title
Figure 6.16

Otter and Water Vole Survey

Scheme: 0405, Temple Sowerby to Appleby
Sheet 5 of 15

Map Number	Project	Originator	Volume
HE565627	-	AMY	-
S00	-	MP	-
Location	Type	Role	Number
S4	FIT FOR STAGE APPROVAL		P02

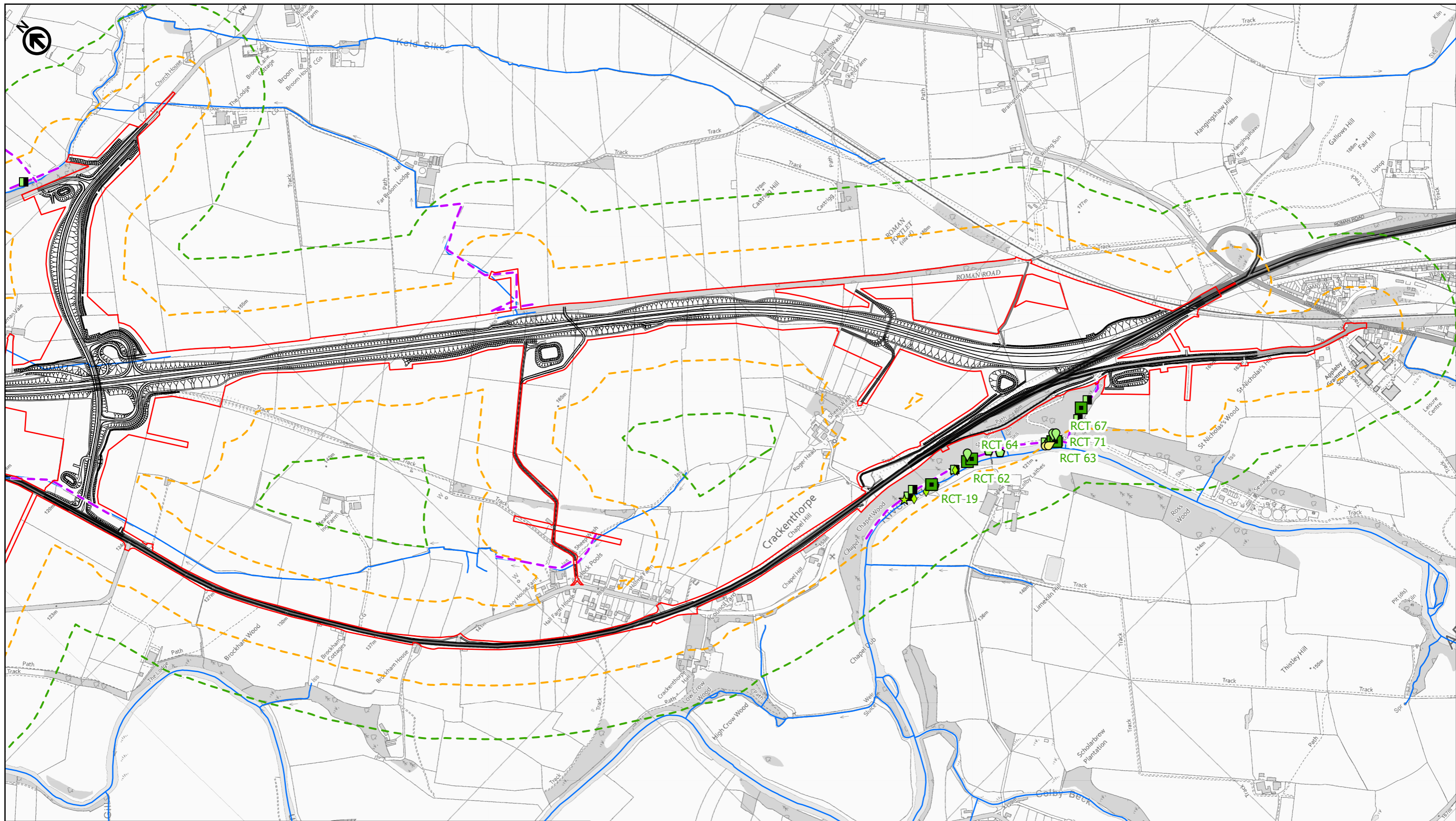

<ul style="list-style-type: none"> — Route Alignment — Existing A66 — Order Limits — Study Area 100m — Study Area 250m ■ Camera Trap — Watercourses — Mammal Riparian Walking Transect Routes 	<p>Camera Trap Sightings</p> <ul style="list-style-type: none"> ● Otter ● Otter Cubs ● Otter Holt <p>Incidental Records</p> <ul style="list-style-type: none"> ▲ Water Vole ▲ Otter <p>Water Vole Field Signs</p> <ul style="list-style-type: none"> ▲ Feeding Stations/Signs ● Other 	<p>Otter Field Signs</p> <ul style="list-style-type: none"> ▲ Feeding Signs ★ Footprints ◆ Unconfirmed Holt/Resting Place ● Other ■ Paths ⊕ Sightings ● Slides ■ Spraint
<p>RCT: Riparian Camera Trap CT: Camera Trap</p>		

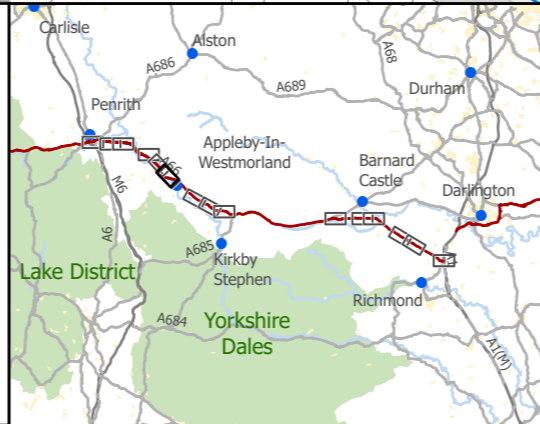

national highways | 3 Piccadilly Place | Manchester | M1 3BN

P02	First Issue				
	EREI	CESL	HWHI	AMIT	KWHA
	23/03/22	17/04/22	22/04/22	22/04/22	22/04/22
Revision	Created	Checked	Reviewed	Approved	Authorised

Kilometres
0 0.25 0.5

Scale @ A3: 1:10,000 | Project Ref No HE565627 | Stage: Stage 3
© Crown copyright and database rights (2022). All rights reserved. OS 100030649.
Contains public sector information licensed under the Open Government Licence v3.0.

Project Name
A66 Northern Trans-Pennine Project

Map Title
Figure 6.16
Otter and Water Vole Survey
Scheme: 0405, Temple Sowerby to Appleby
Sheet 6 of 15

Map Number	Project	Originator	Volume
HE565627	-	AMY	- EBD
S00	-	MP	- LB - 003171
Location	Type	Role	Number
S4	FIT FOR STAGE APPROVAL		P02

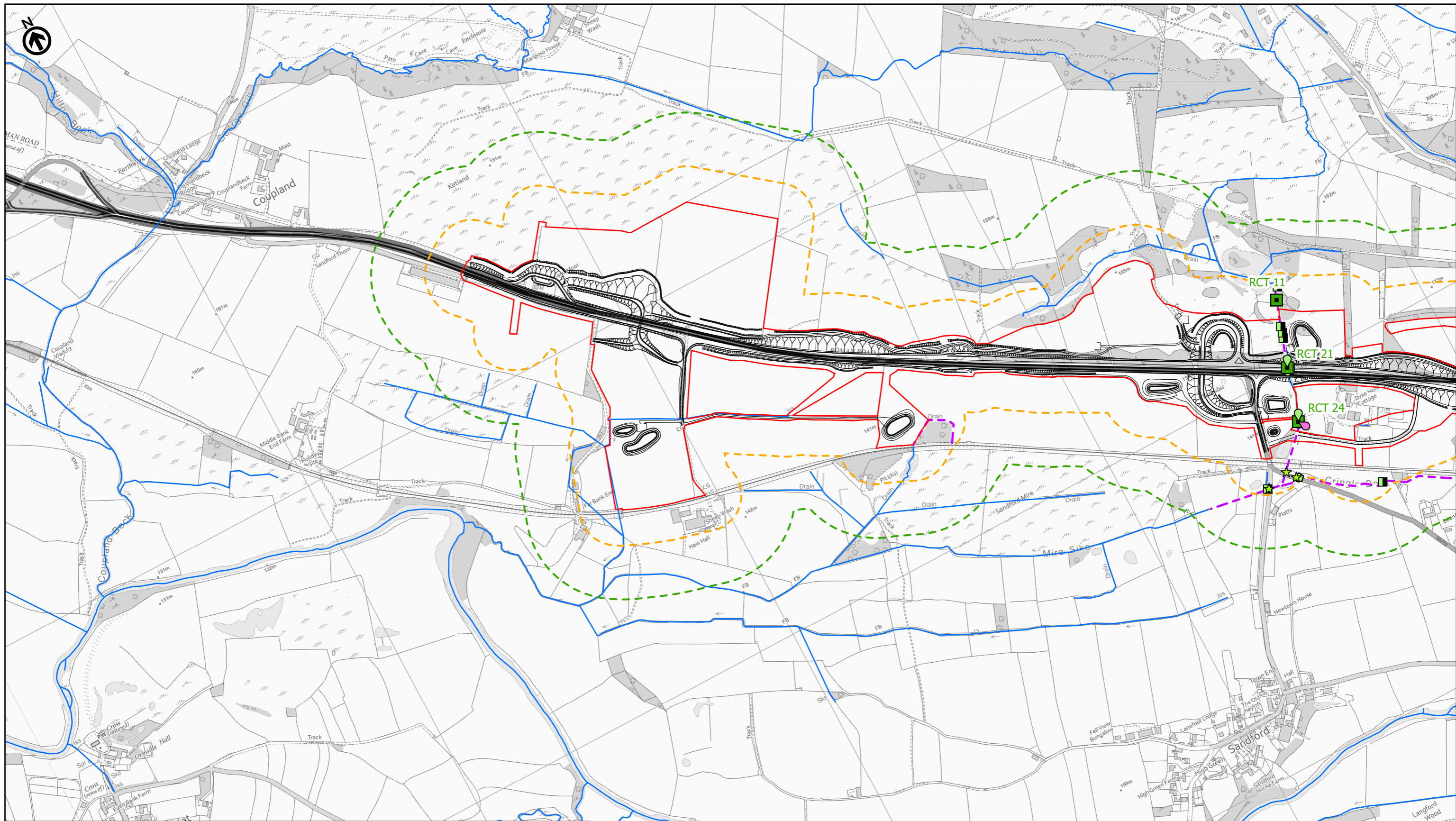

<ul style="list-style-type: none"> Route Alignment Existing A66 Order Limits Study Area 100m Study Area 250m Camera Trap Watercourses Mammal Riparian Walking Transect Routes 	<p>Camera Trap Sightings</p> <ul style="list-style-type: none"> Green diamond: Otter Pink diamond: Otter Cubs Yellow diamond: Otter Holt <p>Incidental Records</p> <ul style="list-style-type: none"> Blue triangle: Water Vole Green triangle: Otter <p>Water Vole Field Signs</p> <ul style="list-style-type: none"> Brown circle: Feeding Stations/Signs Orange circle: Other 	<p>Otter Field Signs</p> <ul style="list-style-type: none"> Green diamond: Feeding Signs Yellow star: Footprints Green diamond: Unconfirmed Holt/Resting Place Green circle: Other Green square: Paths Green cross: Sightings Green circle: Slides Green square: Spraint
---	--	---

RCT: Riparian Camera Trap
CT: Camera Trap

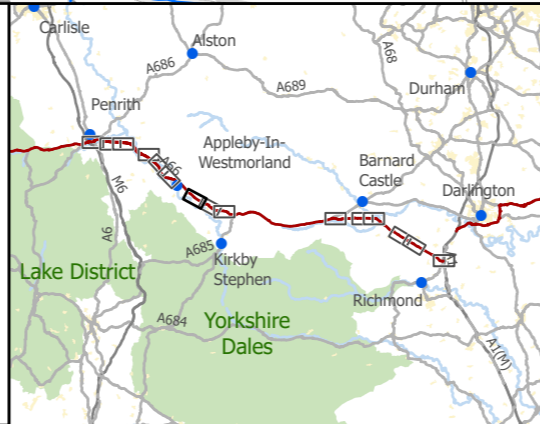

national highways

3 Piccadilly Place
Manchester
M1 3BN

P02	First Issue				
	EREI	CESL	HWHI	AMIT	KWHA
	23/03/22	17/04/22	22/04/22	22/04/22	22/04/22
Revision	Created	Checked	Reviewed	Approved	Authorised

Kilometres
0 0.25 0.5

Scale @ A3: 1:10,000 | Project Ref No HE565627 | Stage: Stage 3
© Crown copyright and database rights (2022). All rights reserved. OS 100030649.
Contains public sector information licensed under the Open Government Licence v3.0.

Project Name
A66 Northern Trans-Pennine Project

Map Title
Figure 6.16
Otter and Water Vole Survey
Scheme: 06, Appleby to Brough
Sheet 7 of 15

Map Number	Project	Originator	Volume
HE565627	S00	AMY	EBD
Location	Type	Role	Number
S4	FIT FOR STAGE APPROVAL	MP - LB	003172

Suitability	Suitability Description	Revision
S4	FIT FOR STAGE APPROVAL	P02

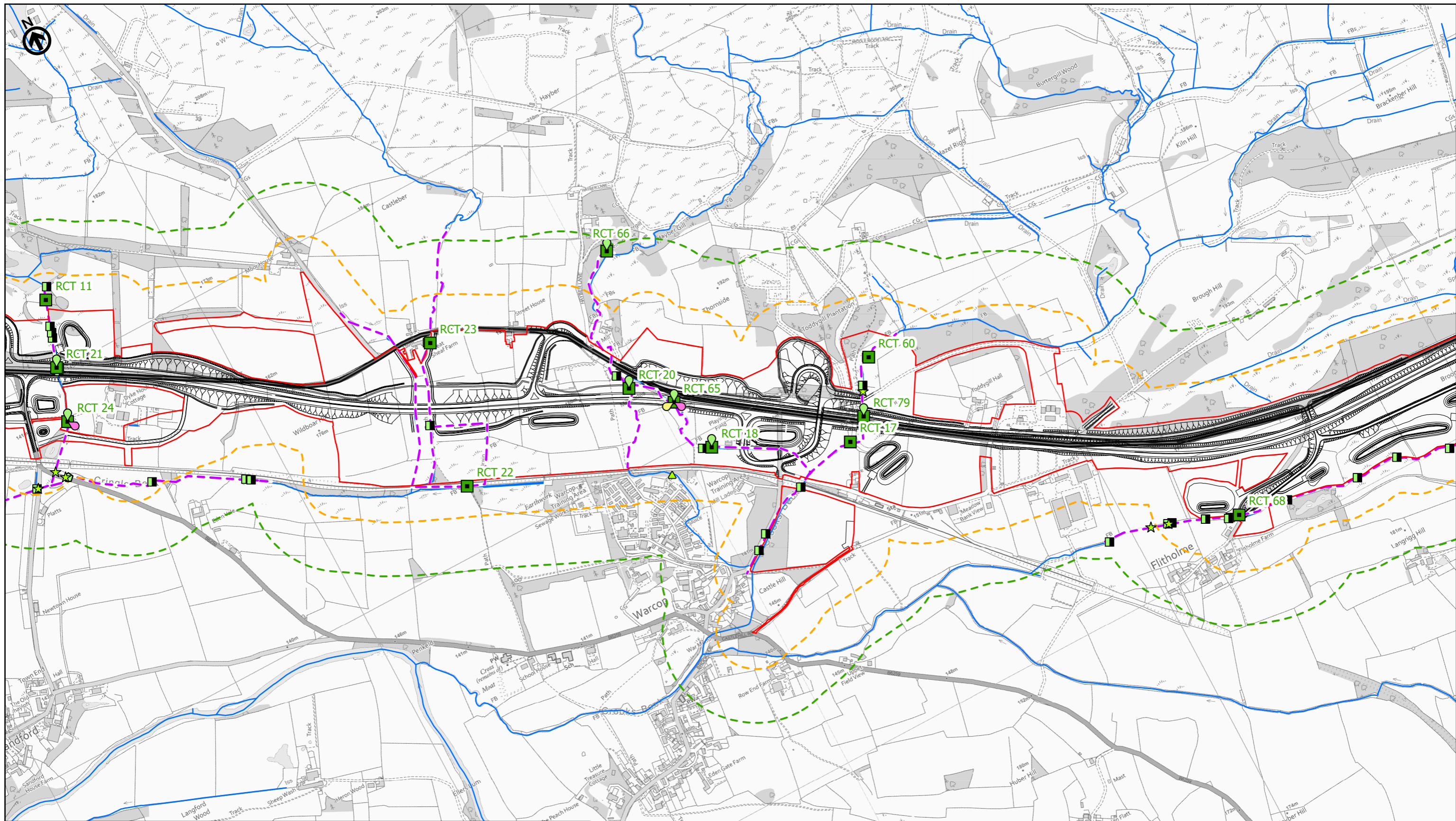

<ul style="list-style-type: none"> — Route Alignment — Existing A66 — Order Limits - - - Study Area 100m - - - Study Area 250m ■ Camera Trap — Watercourses - - - Mammal Riparian Walking Transect Routes 	<p>Camera Trap Sightings</p> <ul style="list-style-type: none"> ● Otter ● Otter Cubs ● Otter Holt <p>Incidental Records</p> <ul style="list-style-type: none"> ▲ Water Vole ▲ Otter <p>Water Vole Field Signs</p> <ul style="list-style-type: none"> ▲ Feeding Stations/Signs ● Other 	<p>Otter Field Signs</p> <ul style="list-style-type: none"> ■ Feeding Signs ★ Footprints ◆ Unconfirmed Holt/Resting Place ● Other ■ Paths ⊕ Sightings ● Slides ■ Spraint
<p>RCT: Riparian Camera Trap CT: Camera Trap</p>		

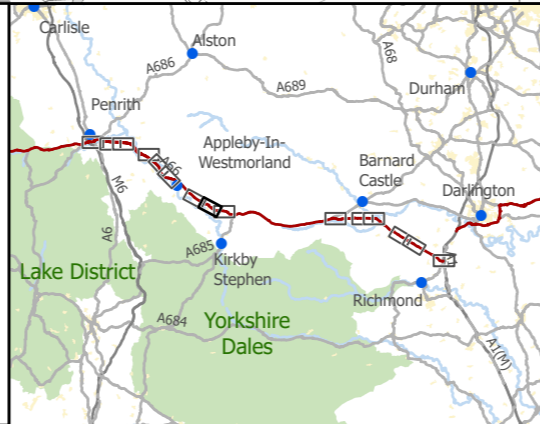

national highways

3 Piccadilly Place
Manchester
M1 3BN

P02	First Issue				
	EREI	CESL	HWHI	AMIT	KWHA
	23/03/22	17/04/22	22/04/22	22/04/22	22/04/22
Revision	Created	Checked	Reviewed	Approved	Authorised

Kilometres

0 0.25 0.5

Scale @ A3: 1:10,000 | Project Ref No HE565627 | Stage: Stage 3
© Crown copyright and database rights (2022). All rights reserved. OS 100030649.
Contains public sector information licensed under the Open Government Licence v3.0.

Project Name A66 Northern Trans-Pennine Project			
Map Title Figure 6.16			
Scheme: 06, Appleby to Brough			
Sheet 8 of 15			
Map Number	Project	Originator	Volume
HE565627	-	AMY	-
S00	-	MP - LB	-
Location	Type	Role	Number
S4	FIT FOR STAGE APPROVAL		P02

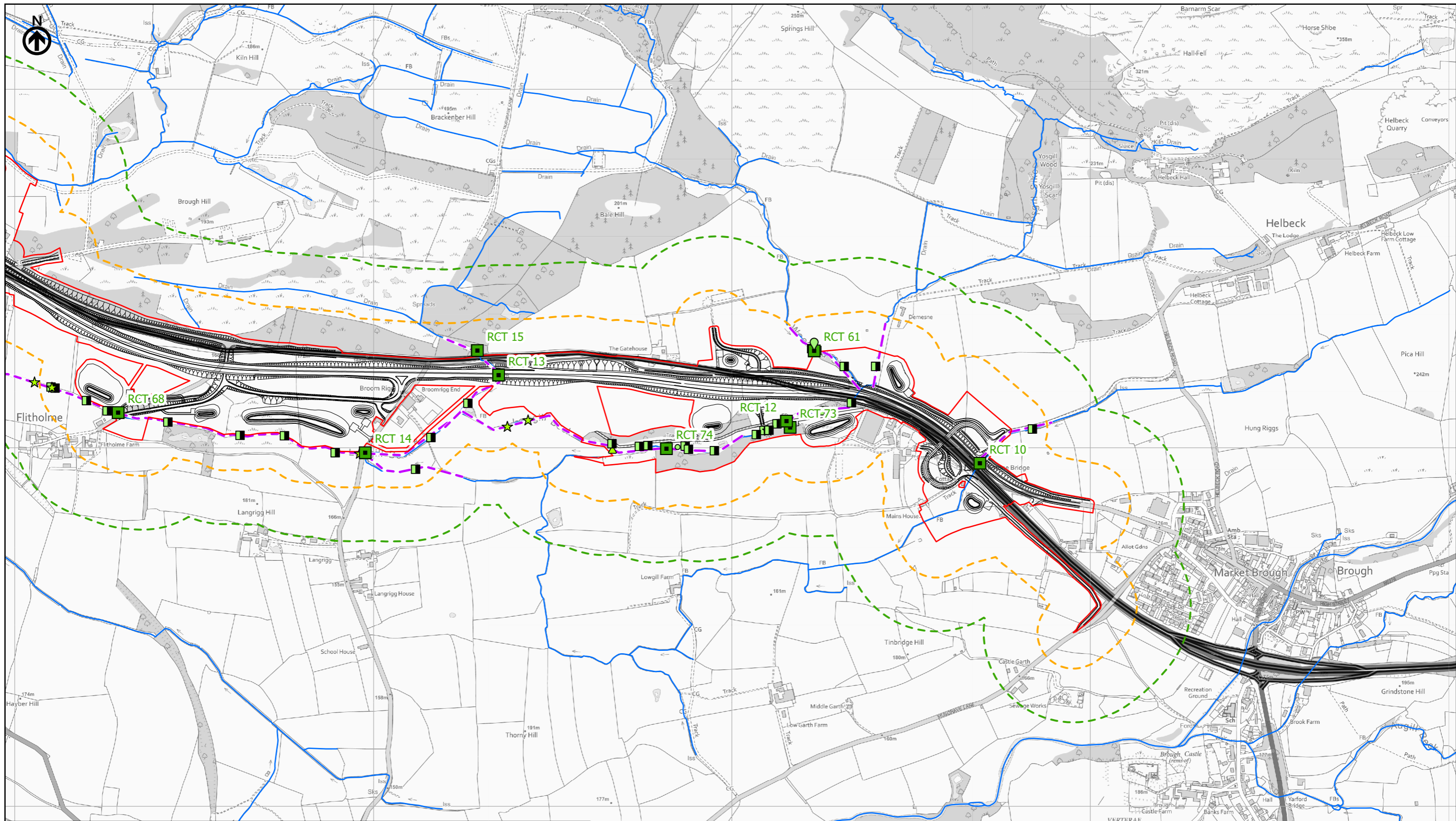

<ul style="list-style-type: none"> — Route Alignment — Existing A66 — Order Limits — Study Area 100m — Study Area 250m ■ Camera Trap — Watercourses — Mammal Riparian Walking Transect Routes 	<p>Camera Trap Sightings</p> <ul style="list-style-type: none"> ● Otter ● Otter Cubs ● Otter Holt ▲ Water Vole ▲ Otter ▲ Water Vole Field Signs ● Feeding Stations/Signs ● Other 	<p>Otter Field Signs</p> <ul style="list-style-type: none"> ■ Feeding Signs ★ Footprints ◆ Unconfirmed Holt/Resting Place ● Other ■ Paths ✚ Sightings ● Slides ■ Spraint
<p>RCT: Riparian Camera Trap CT: Camera Trap</p>		

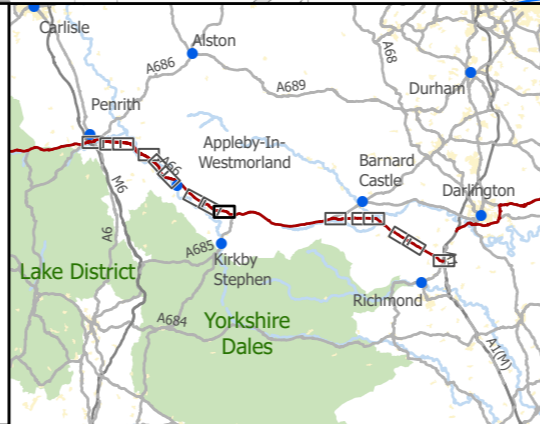

national highways 3 Piccadilly Place Manchester M1 3BN

P02	First Issue				
	EREI	CESL	HWHI	AMIT	KWHA
	23/03/22	17/04/22	22/04/22	22/04/22	22/04/22
Revision	Created	Checked	Reviewed	Approved	Authorised

Kilometres
0 0.25 0.5

Scale @ A3: 1:10,000 | Project Ref No HE565627 | Stage: Stage 3
© Crown copyright and database rights (2022). All rights reserved. OS 100030649.
Contains public sector information licensed under the Open Government Licence v3.0.

Project Name
A66 Northern Trans-Pennine Project

Map Title
Figure 6.16
Otter and Water Vole Survey
Scheme: 06, Appleby to Brough
Sheet 9 of 15

Map Number	Project	Originator	Volume
HE565627	-	AMY	-
S00	-	MP	-
Location	Type	Role	Number
S4	FIT FOR STAGE APPROVAL		P02

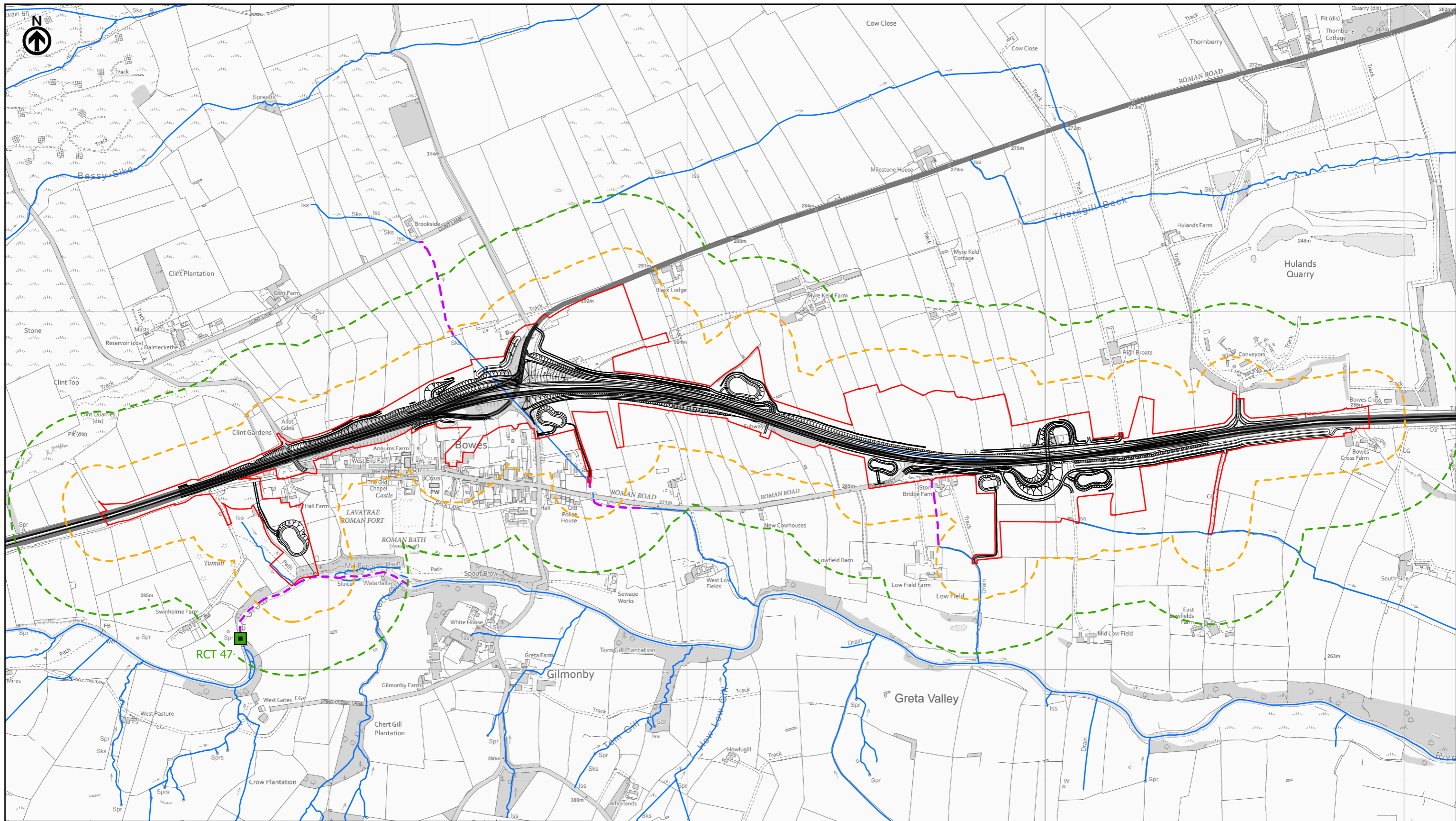

<ul style="list-style-type: none"> — Route Alignment — Existing A66 — Order Limits — Study Area 100m — Study Area 250m ■ Camera Trap — Watercourses — Mammal Riparian Walking Transect Routes 	<p>Camera Trap Sightings</p> <ul style="list-style-type: none"> ● Otter ● Otter Cubs ● Otter Holt <p>Incidental Records</p> <ul style="list-style-type: none"> ▲ Water Vole ▲ Otter <p>Water Vole Field Signs</p> <ul style="list-style-type: none"> ▲ Feeding Stations/Signs ● Other 	<p>Otter Field Signs</p> <ul style="list-style-type: none"> ◆ Feeding Signs ★ Footprints ◆ Unconfirmed Holt/Resting Place ● Other ■ Paths ⊕ Sightings ● Slides ■ Spraint
---	---	---

RCT: Riparian Camera Trap
CT: Camera Trap

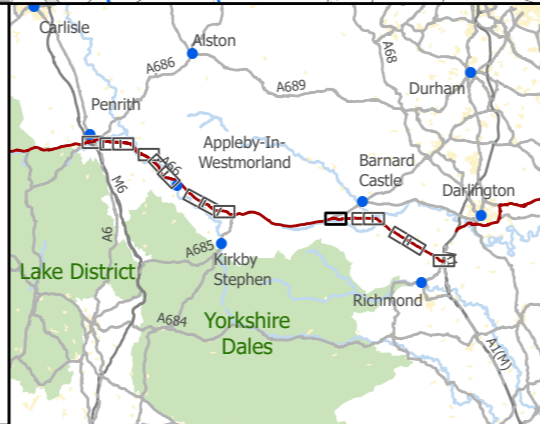

national highways

3 Piccadilly Place
Manchester
M1 3BN

P02	First Issue				
	EREI	CESL	HWHI	AMIT	KWHA
	23/03/22	17/04/22	22/04/22	22/04/22	22/04/22
Revision	Created	Checked	Reviewed	Approved	Authorised

Kilometres

0 0.25 0.5

Scale @ A3: 1:10,000 | Project Ref No HE565627 | Stage: Stage 3
© Crown copyright and database rights (2022). All rights reserved. OS 100030649.
Contains public sector information licensed under the Open Government Licence v3.0.

Project Name A66 Northern Trans-Pennine Project			
Map Title Figure 6.16			
Scheme: 07, Bowes Bypass			
Sheet 10 of 15			
Map Number Project	Originator	Volume	
HE565627	AMY	EBD	
Location		Type	Role
S00		MP	LB
S00		- 003175	
Suitability	Suitability Description		Revision
S4	FIT FOR STAGE APPROVAL		P02

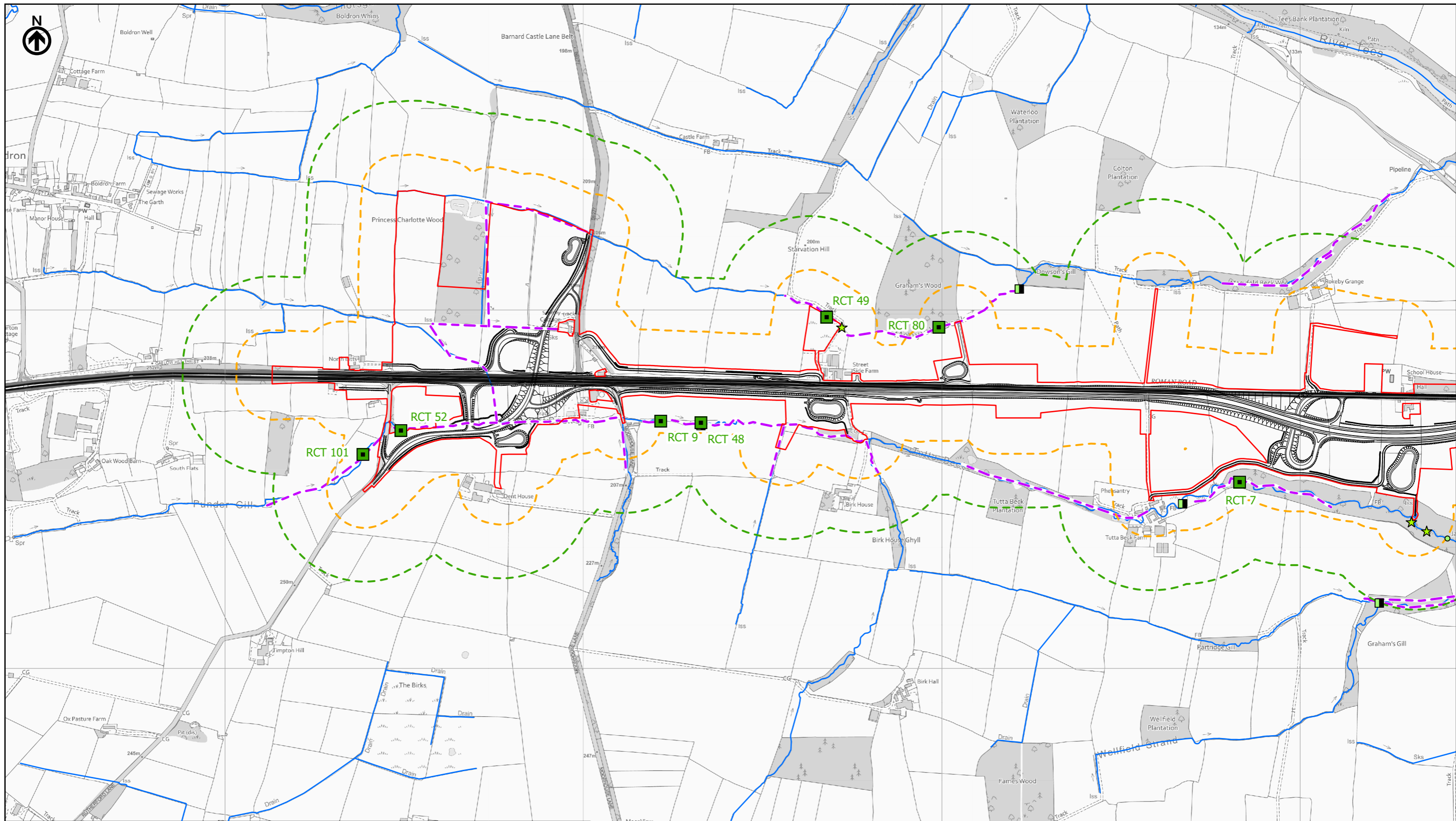

— Route Alignment
 — Existing A66
 [Red Outline] Order Limits
 [Orange Dashed] Study Area 100m
 [Green Dashed] Study Area 250m
 [Green Square] Camera Trap
 [Blue Line] Watercourses
 [Purple Dashed] Mammal Riparian Walking Transect Routes
 RCT: Riparian Camera Trap
 CT: Camera Trap

Camera Trap Sightings
 [Green Diamond] Otter
 [Pink Diamond] Otter Cubs
 [Yellow Diamond] Otter Holt
 [Brown Triangle] Water Vole
 [Green Triangle] Otter
 [Brown Triangle] Feeding Stations/Signs
 [Orange Circle] Other

Incidental Records
 [Brown Triangle] Water Vole
 [Green Triangle] Otter
 [Brown Triangle] Feeding Stations/Signs
 [Orange Circle] Other

Otter Field Signs
 [Green Diamond] Feeding Signs
 [Yellow Star] Footprints
 [Green Diamond] Unconfirmed Holt/Resting Place
 [Green Circle] Other
 [Green Square] Paths
 [Green Plus] Sightings
 [Green Circle] Slides
 [Green Square] Spraint

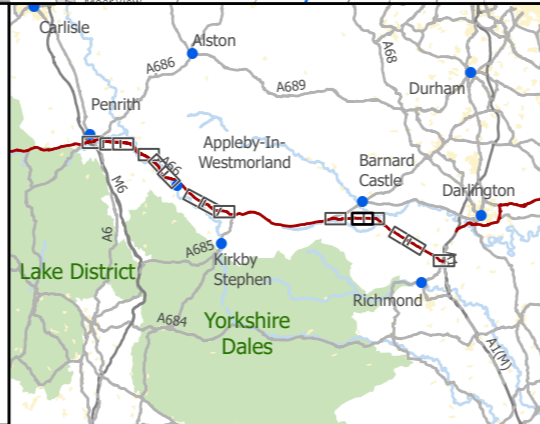

national highways
 3 Piccadilly Place
 Manchester
 M1 3BN

P02	First Issue				
	EREI	CESL	HWHI	AMIT	KWHA
	23/03/22	17/04/22	22/04/22	22/04/22	22/04/22
Revision	Created	Checked	Reviewed	Approved	Authorised

Scale @ A3: 1:10,000 | Project Ref No HE565627 | Stage: Stage 3
 © Crown copyright and database rights (2022). All rights reserved. OS 100030649.
 Contains public sector information licensed under the Open Government Licence v3.0.

Project Name
A66 Northern Trans-Pennine Project

Map Title
Figure 6.16
Otter and Water Vole Survey
 Scheme: 08, Cross Lanes to Rokeby
 Sheet 11 of 15

Map Number	Project	Originator	Volume
HE565627	-	AMY	- EBD
S00	-	MP	- LB - 003176
Location	Type	Role	Number
S4	FIT FOR STAGE APPROVAL		P02

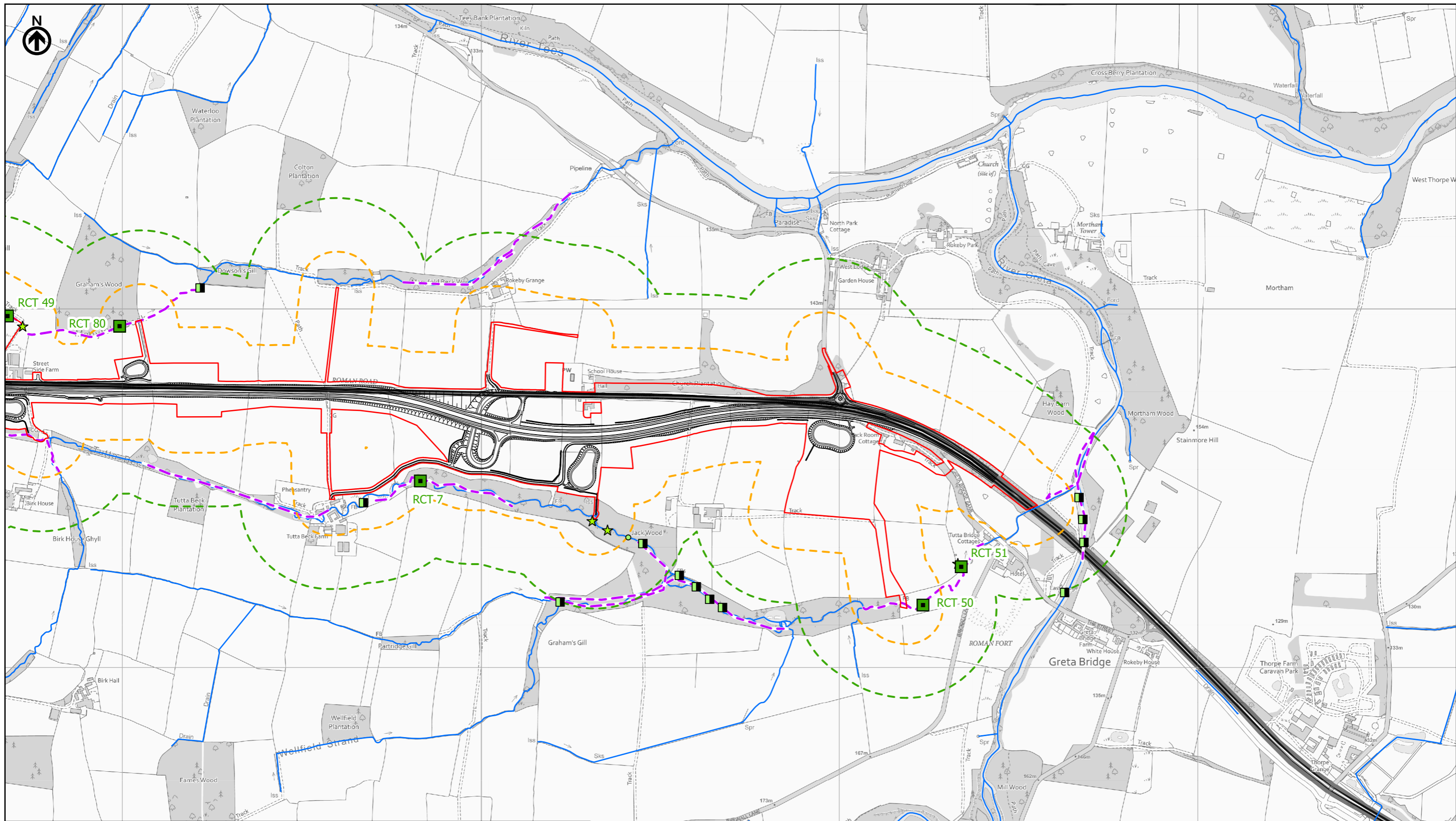

<ul style="list-style-type: none"> — Route Alignment — Existing A66 — Order Limits - - - Study Area 100m - - - Study Area 250m ■ Camera Trap — Watercourses - - - Mammal Riparian Walking Transect Routes 	<p>Camera Trap Sightings</p> <ul style="list-style-type: none"> ● Otter ● Otter Cubs ● Otter Holt <p>Incidental Records</p> <ul style="list-style-type: none"> ▲ Water Vole ▲ Otter <p>Water Vole Field Signs</p> <ul style="list-style-type: none"> ▲ Feeding Stations/Signs ● Other 	<p>Otter Field Signs</p> <ul style="list-style-type: none"> ■ Feeding Signs ★ Footprints ◆ Unconfirmed Holt/Resting Place ● Other ■ Paths ■ Sightings ■ Slides ■ Spraint
---	---	---

RCT: Riparian Camera Trap
CT: Camera Trap

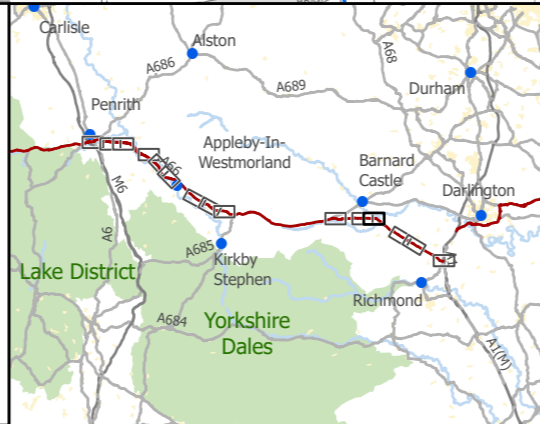

national highways

3 Piccadilly Place
Manchester
M1 3BN

P02	First Issue				
	EREI	CESL	HWHI	AMIT	KWHA
	23/03/22	17/04/22	22/04/22	22/04/22	22/04/22
Revision	Created	Checked	Reviewed	Approved	Authorised

Kilometres

0 0.25 0.5

Scale @ A3: 1:10,000 | Project Ref No HE565627 | Stage: Stage 3
© Crown copyright and database rights (2022). All rights reserved. OS 100030649.
Contains public sector information licensed under the Open Government Licence v3.0.

Project Name A66 Northern Trans-Pennine Project			
Map Title Figure 6.16			
Scheme: 08, Cross Lanes to Rokeby			
Sheet 12 of 15			
Map Number Project	Originator	Volume	
HE565627	AMY	EBD	
S00	MP	LB	003179
Location	Type	Role	Number
Suitability S4	Suitability Description FIT FOR STAGE APPROVAL		Revision P02

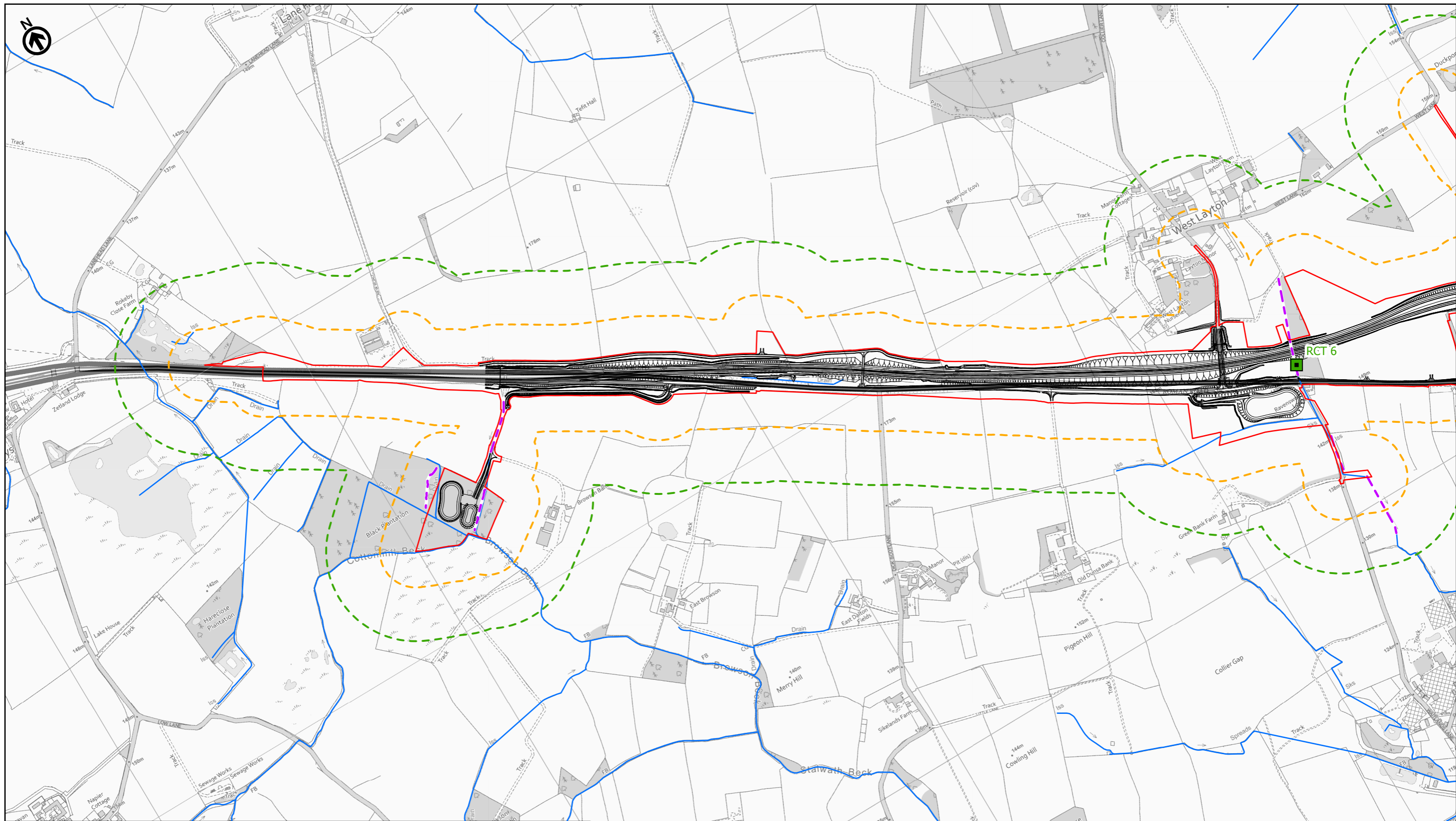

<ul style="list-style-type: none"> — Route Alignment — Existing A66 — Order Limits — Study Area 100m — Study Area 250m ■ Camera Trap — Watercourses — Mammal Riparian Walking Transect Routes 	<p>Camera Trap Sightings</p> <ul style="list-style-type: none"> ● Otter ● Otter Cubs ● Otter Holt <p>Incidental Records</p> <ul style="list-style-type: none"> ▲ Water Vole ▲ Otter <p>Water Vole Field Signs</p> <ul style="list-style-type: none"> ▲ Feeding Stations/Signs ● Other 	<p>Otter Field Signs</p> <ul style="list-style-type: none"> ▲ Feeding Signs ★ Footprints ◆ Unconfirmed Holt/Resting Place ● Other ■ Paths ⊕ Sightings ● Slides ■ Spraint
---	---	---

RCT: Riparian Camera Trap
CT: Camera Trap

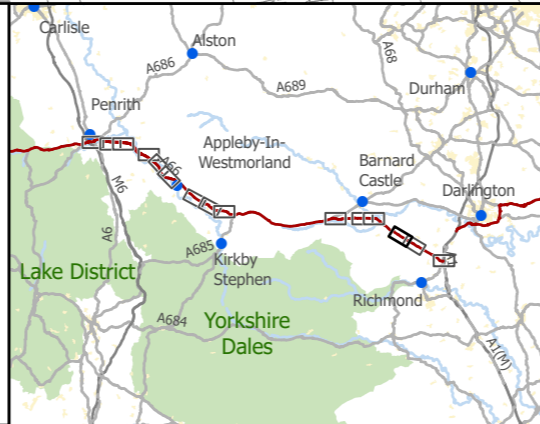

national highways

3 Piccadilly Place
Manchester
M1 3BN

P02	First Issue				
	EREI	CESL	HWHI	AMIT	KWHA
	23/03/22	17/04/22	22/04/22	22/04/22	22/04/22
Revision	Created	Checked	Reviewed	Approved	Authorised

Scale @ A3: 1:10,000 | Project Ref No HE565627 | Stage: Stage 3
© Crown copyright and database rights (2022). All rights reserved. OS 100030649.
Contains public sector information licensed under the Open Government Licence v3.0.

Project Name A66 Northern Trans-Pennine Project			
Map Title Figure 6.16			
Scheme: 09, Stephen Bank to Carkin Moor			
Sheet 13 of 15			
Map Number Project	Originator	Volume	
HE565627	AMY	EBD	
S00	-	MP	LB - 003177
Location	Type	Role	Number
Suitability S4	Suitability Description FIT FOR STAGE APPROVAL		Revision P02

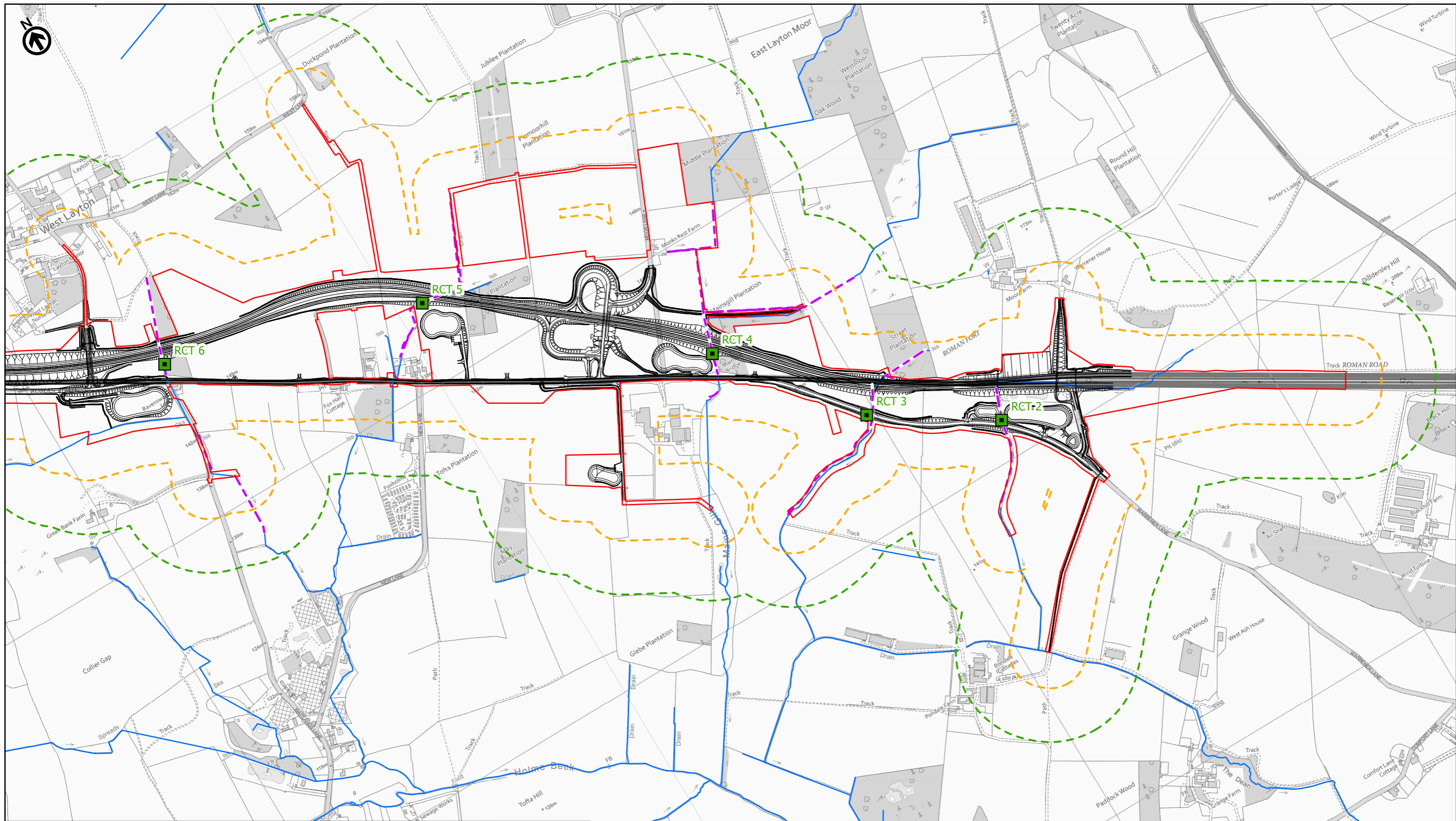

— Route Alignment
 — Existing A66
 [Red Outline] Order Limits
 [Dashed Orange] Study Area 100m
 [Dashed Green] Study Area 250m
 [Green Square] Camera Trap
 [Blue Line] Watercourses
 [Purple Line] Mammal Riparian Walking Transect Routes
 RCT: Riparian Camera Trap
 CT: Camera Trap

Camera Trap Sightings
 [Green Diamond] Otter
 [Pink Diamond] Otter Cubs
 [Yellow Diamond] Otter Holt
 [Brown Triangle] Water Vole
 [Green Triangle] Otter
 [Brown Triangle] Feeding Stations/Signs
 [Orange Circle] Other

Incidental Records
 [Brown Triangle] Water Vole
 [Green Triangle] Otter
 [Brown Triangle] Feeding Stations/Signs
 [Orange Circle] Other

Otter Field Signs
 [Green Diamond] Feeding Signs
 [Yellow Star] Footprints
 [Green Diamond] Unconfirmed Holt/Resting Place
 [Green Circle] Other
 [Green Square] Paths
 [Green Plus] Sightings
 [Green Circle] Slides
 [Green Square] Spraint

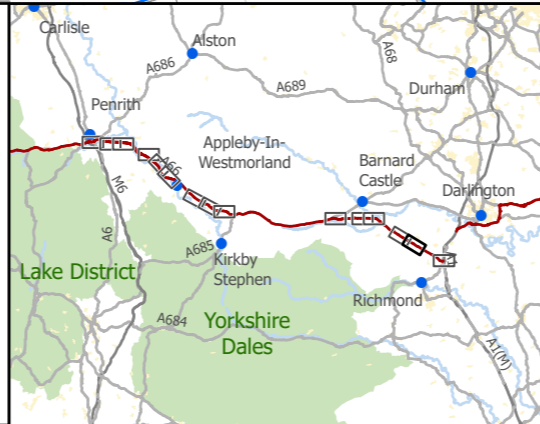

national highways
 3 Piccadilly Place
 Manchester
 M1 3BN

P02	First Issue				
	EREI	CESL	HWHI	AMIT	KWHA
	23/03/22	17/04/22	22/04/22	22/04/22	22/04/22
Revision	Created	Checked	Reviewed	Approved	Authorised

Scale @ A3: 1:10,000 | Project Ref No HE565627 | Stage: Stage 3
 © Crown copyright and database rights (2022). All rights reserved. OS 100030649.
 Contains public sector information licensed under the Open Government Licence v3.0.

Project Name
A66 Northern Trans-Pennine Project

Map Title
Figure 6.16
Otter and Water Vole Survey
 Scheme: 09, Stephen Bank to Carkin Moor
 Sheet 14 of 15

Map Number	Project	Originator	Volume
HE565627	-	AMY	-
S00	-	MP	-
Location	Type	Role	Number
S4	FIT FOR STAGE APPROVAL		P02

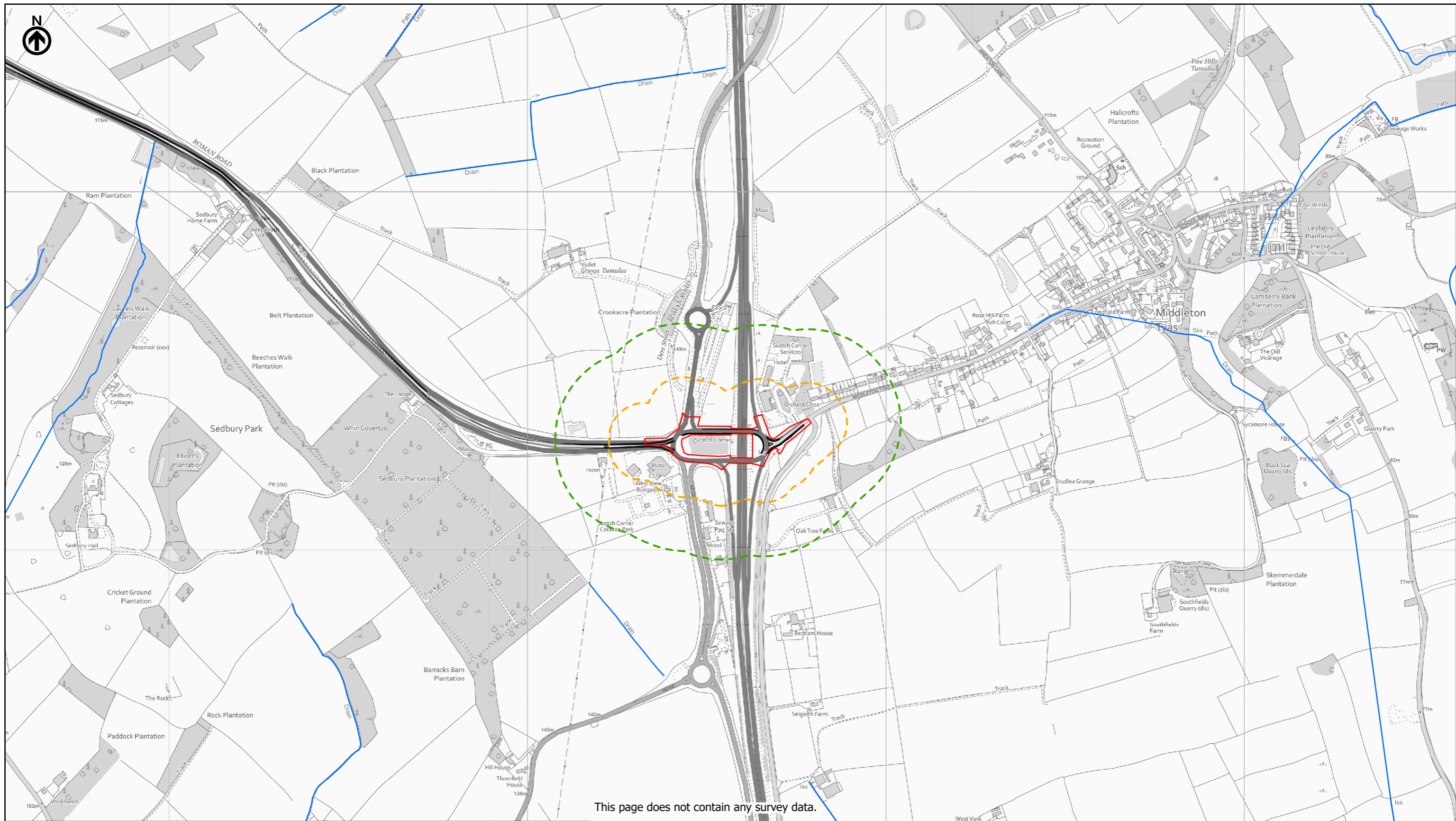

This page does not contain any survey data.

<ul style="list-style-type: none"> — Route Alignment — Existing A66 — Order Limits — Study Area 100m — Study Area 250m ■ Camera Trap — Watercourses — Mammal Riparian Walking Transect Routes 	<p>Camera Trap Sightings</p> <ul style="list-style-type: none"> ● Otter ● Otter Cubs ● Otter Holt <p>Incidental Records</p> <ul style="list-style-type: none"> ▲ Water Vole ▲ Otter <p>Water Vole Field Signs</p> <ul style="list-style-type: none"> ● Feeding Stations/Signs ● Other 	<p>Otter Field Signs</p> <ul style="list-style-type: none"> ● Feeding Signs ★ Footprints ◆ Unconfirmed Holt/Resting Place ● Other ■ Paths ■ Sightings ■ Slides ■ Spraint
---	---	---

RCT: Riparian Camera Trap
CT: Camera Trap

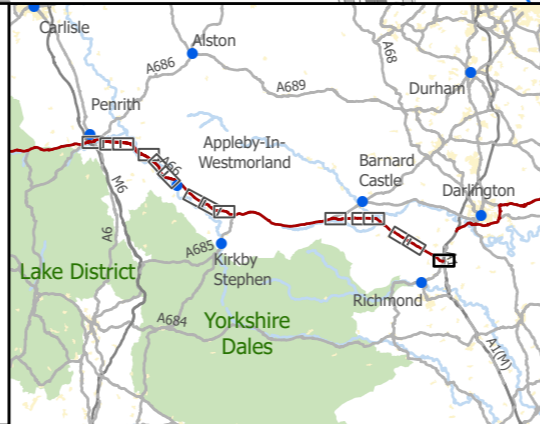

national highways

3 Piccadilly Place
Manchester
M1 3BN

P02	First Issue				
	EREI	CESL	HWHI	AMIT	KWHA
	23/03/22	17/04/22	22/04/22	22/04/22	22/04/22
Revision	Created	Checked	Reviewed	Approved	Authorised

Kilometres
0 0.25 0.5

Scale @ A3: 1:10,000 | Project Ref No HE565627 | Stage: Stage 3
© Crown copyright and database rights (2022). All rights reserved. OS 100030649.
Contains public sector information licensed under the Open Government Licence v3.0.

Project Name
A66 Northern Trans-Pennine Project

Map Title
Figure 6.16
Otter and Water Vole Survey

Scheme: 11, A1(M) Junction 53 Scotch Corner
Sheet 15 of 15

Map Number	Project	Originator	Volume
HE565627	-	AMY	- EBD
S00	-	MP	- LB - 003166
Location	Type	Role	Number
S4	FIT FOR STAGE APPROVAL		P02